

# 1070

USER'S MANUAL

PATENTS:  
201730157875.7

PRECAUTIONS



Caveat

2

Keep away from children

Do not store this product where children can reach. This product may cause accidental personal injury when parts such as blades or lubricating oil bottle are placed in the mouth.

Do not plug or unplug the power adapter with wet hands

In order to avoid personal injury due to electric shock

Do not clean or maintain the unit while it is charging.

Please power-off the product before cleaning and maintenance to avoid short circuit or electric shock.

Never use a non-factory-configured power adapter to charge the product

To prevent the fire from happening due to overheating of the charging line due to different power adapter specifications.

Do not use accessories other than this product

In order to avoid unnecessary loss due to the matching of structure or material composition.

Do not modify or repair the product yourself

Some components of this product are precision components, and non-professionals should not disassemble and modify them to avoid malfunction of the fuselage.

Please check the blade for damage or deformation before use.

Failure to do so may result in hurting your skin.

Do not place this product in a very high or very low temperature.

Doing so may damage the battery or reduce the battery life of this product.

If the product is abnormal or malfunctioning, please stop using the product immediately.

Failure to do so may result in fire, electric shock or injury.

Abnormal condition:

The main unit or power adapter is deformed or abnormally hot; the host or power adapter has a burnt smell; an abnormal sound occurs when the main unit or power supply is in use

return the product to the dealer or manufacturer for inspection or repair.



Precautions

This product contains a built-in rechargeable lithium battery.

Do not charge it in a high temperature environment.

Failure to do so may result in overheating, fire or explosion.

Be sure to use the power supply that matches the rated voltage indicated on the power adapter.

Failure to do so may result in malfunction or fire.

Be sure to fully insert the power adapter plug into the socket while charging.

Failure to do so may result in fire or electric shock.

Please operate away from water-filled containers or chemicals.

In order to avoid line failure or fire caused by moisture or corrosion.

Do not immerse the product in the water or rinse the body with water.

Doing so may cause a short circuit and result in electric shock or fire.

If you accidentally swallow the oil, do not induce vomiting. Please drink a lot of drinking water and see the doctor.

If there is any contact with the eyes, please rinse immediately with water and then send to the doctor.

Do not replace the power adapter power cord by yourself.

If the power cord is damaged, please replace the original power adapter.

Otherwise, it may cause electric shock.

Regularly clean the power adapter plug and the host power interface dust and foreign objects

Failure to do so may result in electric shock or fire due to a short circuit.

Do not press the blade to the skin or use the hair clipper for any purpose other than hair cutting.

Failure to do so may result in skin injury

Unplug the power adapter from the power outlet when it is not in use for a long time.

Otherwise, leakage may occur due to insulation aging, resulting in electric shock or fire.

When plugging or unplugging the power adapter, hold the insulation part of the power adapter plug, not the power cord

3

English

English

## PRODUCT OVERVIEW

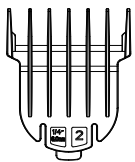
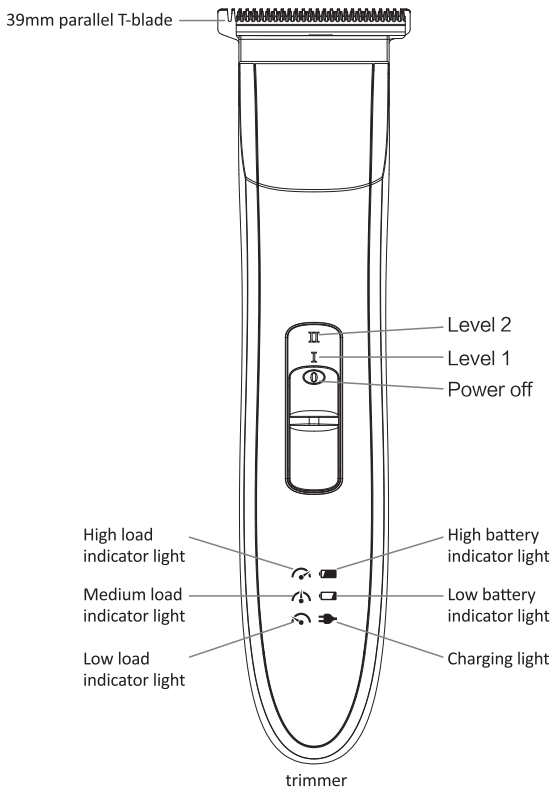

2# Guard

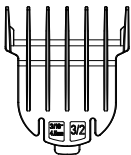

3/2# Guard

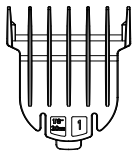

1# Guard

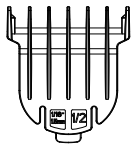

1/2# Guard

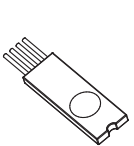

Cleaning brush



Lubricating oil



Charger adapter



## Caveat

- **Disassemble the battery and do not place it in a place where children or babies can reach it.**

If you accidentally swallow the battery, it will hurt your body. If this happens, please seek medical treatment immediately.

- **If the battery leaks, take the following measures. Never touch the battery with bare hands**

If the battery liquid comes into contact with your eyes, it may cause blindness. Do not rub your eyes. Please wash with water and seek medical treatment immediately. Battery liquid that comes into contact with skin or clothing may cause inflammation or injury. Please wash thoroughly with water and seek medical treatment.



## Danger

This product has a built-in rechargeable lithium battery that can only be used with this product. After removing the battery from the product:

- Do not use with other products;
- Do not perform charging operations;
- Do not throw into fire or heat;
- Do not let the positive and negative terminals of the battery pass through the metal material;
- Do not store the battery together with metal accessories such as necklaces or metal hair clips;
- Do not hit, disassemble, modify or puncture the battery;
- Do not charge, use or store the battery at high temperatures;

It may cause overheating, fire or explosion.

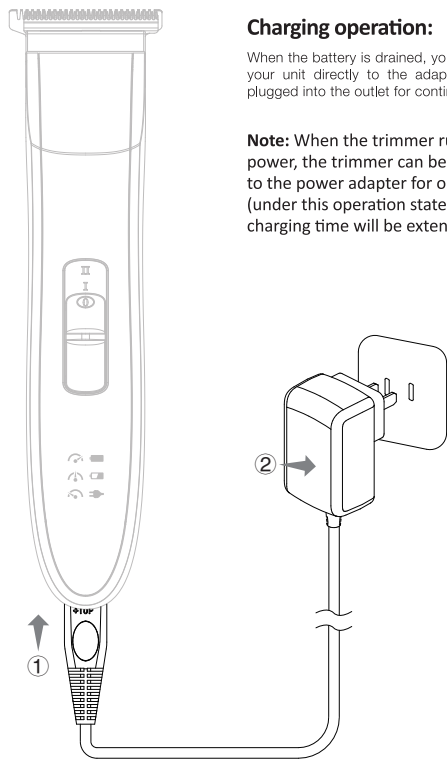
**Charging operation:**

When the battery is drained, you can connect your unit directly to the adapter while it is plugged into the outlet for continued use.

**Note:** When the trimmer runs out of power, the trimmer can be connected to the power adapter for operation (under this operation state, the charging time will be extended).

**LED indicator status**

The LED indicator has the following two functions:

1. During charging, the charging status is indicated;
2. During use, the remaining battery status and the blade load position are indicated.

**LED status description during charging status**

0~10 minutes, ➡ the red indicator light flashes, and it will light up after 10 minutes;  
 when it is 10~30 minutes, ⬜ the white indicator light flashes, ➡ the red indicator light is on;  
 at 30~90 minutes, ⬜ the white indicator light flashes, ➡ the red indicator light is on, ⬜ the white indicator light is off;  
 When fully charged, ⬜ the white indicator light is on, and the ⬜ and ➡ indicators are off.

**LED status description in operation status**

When the battery is fully charged, ⬜ the white indicator light flashes;  
 when the battery is low, ⬜ the white indicator light flashes;  
 When the remaining time is less than 10 minutes, ➡ the red indicator light flashes, reminding the user of charging the host.

**Cleaning and oiling reminder**

When the trimmer is turned on, the load indicator light will display the current host running load status. When the high load indicator light ⚡ flashes, it indicates that the blade needs to be cleaned and oiled;

**High performance lithium ion battery**

3.2V 600mAh

Fast charging in about 1 hour, can use up to 1.5 hours

**Switching on/off the trimmer, gear adjustment operation**

Push the main unit switch/gear button to switch and adjust the position of the main unit. (Note: O: Shutdown; I: Boot / Level 1; II: Level 2)

**How to install, disassemble and use the guard**

The guard is used to match the hair trimmer's ability to retain different lengths when trimming the hair. The length of the retained hair is indicated on each guard (e.g. 1.5mm / 3.0mm / 4.5mm / 6mm).

**◆ Guard installation method:**

As shown in Figure 1 on the right, push the top of the comb to the top of the blade and push it down for installation. When you hear a click, it means that the guard has been installed in place (it should not be loose after the guard is installed). The situation happened).

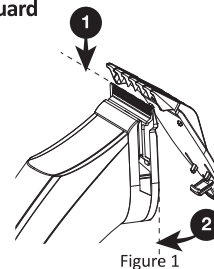
**◆ Guard disassemble method:**

As shown in Figure 2 on the right, pinch the bottom end of the guard with a force and push it outwards to push the guard up. When you hear a click, it means that the guard has been successfully removed.

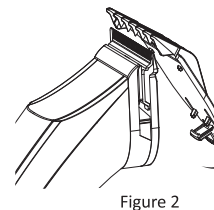

Note: Four guards are only suitable for 39mm parallel T-blade trimmer.

**Method to adjust the blade to 0mm cutting distance**

As shown in the figure below, use a screwdriver to loosen the adjusting screw counterclockwise. Press the thumb flat to adjust the blade so that the upper and lower knives are parallel. Then tighten the screws clockwise. After the adjustment is completed, check whether the moving blade and the fixed blade are parallel. Whether the fixing screw between the fixed blade and the moving blade is tightened, otherwise it may cause harm to the human body during use.

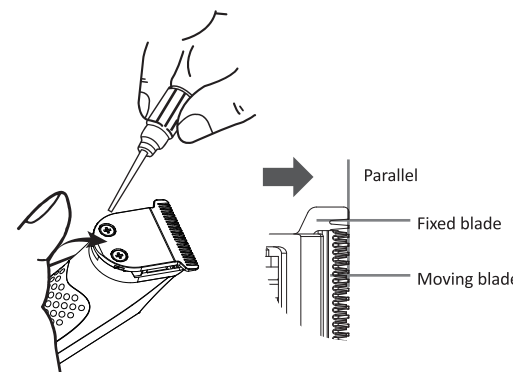

Note: Non-professionals are not allowed to perform this adjustment to avoid unnecessary injury. The company is not responsible for the damage caused.



## MAINTENANCE



Before performing maintenance on the main unit, disconnect the power cord and turn off the trimmer.

### Blade removal, maintenance and installation

#### 8 ◆ Blade removal

As shown in the figure below, hold the trimmer face up with one hand and push it with your thumb to remove the blade (when removing the blade, please catch the blade by hand to avoid falling and damaging the blade).



#### ◆ Blade maintenance

1. Cleaning the blade: Press the top of the movable blade holder as shown in the figure below, and clean the remaining hair between the upper and lower blades with a cleaning brush.

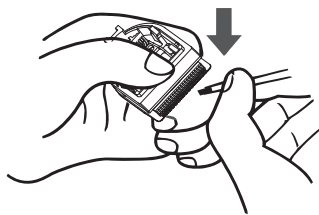

2. Lubricating the blade: inject 1-2 drops of lubricant oil into the 5 positions of the blade as shown below.

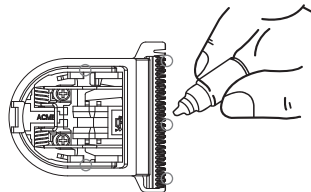

Do not disassemble the blade spring when performing maintenance of the blade, otherwise it may cause malfunction

#### ◆ Blade installation

Hold the trimmer face down with one hand, align the blade with the corresponding position of the main unit and push it down to load the blade (there should be no looseness after installation).

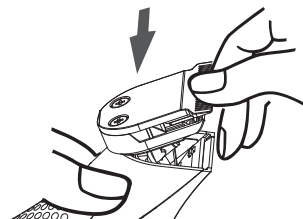

## TROUBLESHOOTING

### Blade jammed with hair

1. Clean the blade and lubricating the blade with oil
2. Replace the blade.

### Blade getting hot

1. Clean the blade and lubricating the blade with oil
2. Replace the blade.

### Clipper does not work

1. Charging the hair trimmer;
2. Return to distributor for maintenance

### Charging no response

1. Check whether the hair trimmer, power adapter and the mains socket are connected
2. Return to distributor for maintenance

### Loud operation sound of trimmer

1. Check if the blade is properly installed.
2. Clean the blade and lubricating the blade with oil

## WARRANTY POLICY / WARRANTY CARD

1. Under normal use and maintenance, the host is guaranteed for one year.
2. Consumable products or parts such as blade, guards, lubricating oil, brushes, etc., not subject to warranty.
3. During the warranty period, if you have one of the following conditions, you will not be repaired for free.
  - Fail to provide the warranty card or the product does not match the contents of this warranty card.
  - Falsification, failure to fill in the contents of the warranty card or altered
  - The purchase date is filled but there is no sales chop or signature
  - Damage caused by failure to use and maintain the product as required by the user's manual (such as dropping, immersion, self-assembly, etc.)
  - Damage caused by force majeure factors such as natural disasters, transportation after purchase, improper storage, etc.
4. This warranty card is the only warranty certificate. Please do not lose it. Warranty card will not be reissued.
5. For products without warranty card or beyond the warranty period, the company will charge for repairs.

Name of Client \_\_\_\_\_

Purchasing date \_\_\_\_\_

Sales point \_\_\_\_\_

Distributor address \_\_\_\_\_